

NOTE: LINEAR TOLERANCES ±0.010" [0.254MM] UNLESS NOTED. CUMULATIVE TOLERANCES NOT TO EXCEED 0.025" [0.625MM] UNLESS NOTED. HOLE TOLERANCES +0.010"/-0.000" [+0.025MM/-0MM] UNLESS NOTED. ANGULAR TOLERANCES NOT TO EXCEED 2° UNLESS NOTED.

HARRIS INSTRUMENT Corporation 155 Johnson Drive Delaware, Ohio 43015 U.S.A.		SCAN LINE ™				
Page 1/1	Size A	Scale 1:3	Drawn by BLA	Date 04/18/06	Approved by	Date
Part Revision	DWG Revision B	EVD #	EPS #	Standard Finish Blue Polane Paint		
Material	N/A			Assembly # N/A		
Drawing Title Dimensions, Model HDPC				Old Drawing # 1295150 Rev B P 1		
				Part # 1406004		

Date	Rev	Record	Auth	ECN #	Reference
					1398186 Pg. 1 HDPC L-1 Interior View
					1398186 Pg. 2 HDPC L-1 Interior View Legend

This drawing copyright 1997 by Harris Instrument Corp. This drawing contains information which is the proprietary property of Harris Instrument Corp. Copies may not be made or the contents disclosed beyond the expressed authorization of Harris Instrument Corp. This print shall be returned upon request. All rights reserved.

Date	Rev	Record	Auth	ECN #	Reference

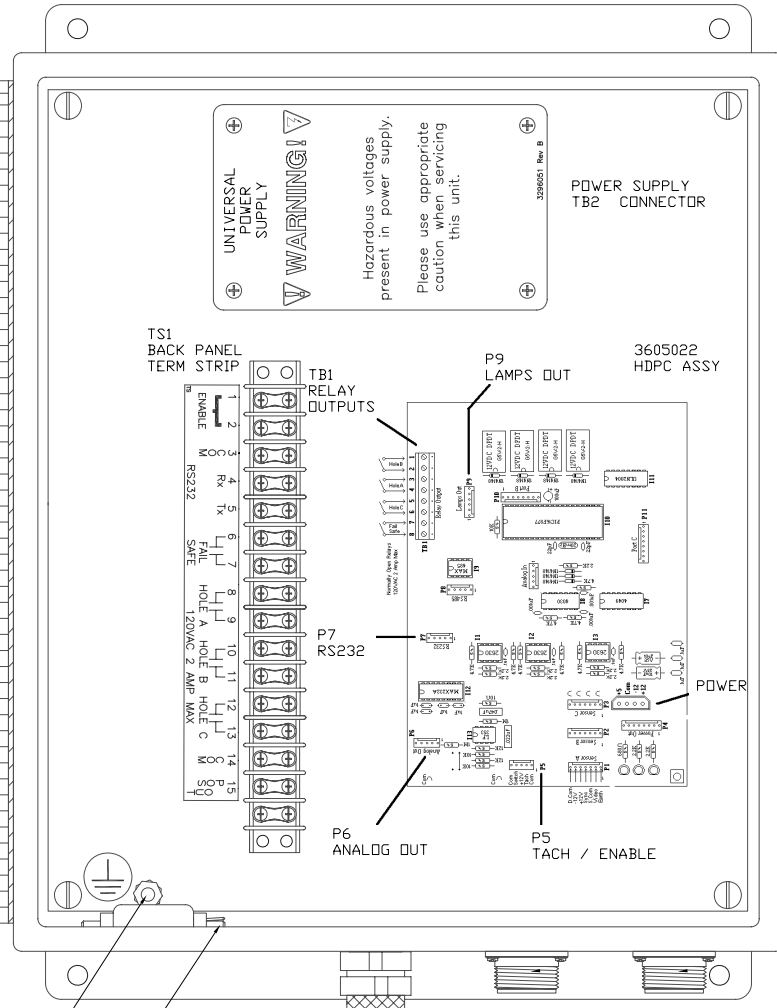
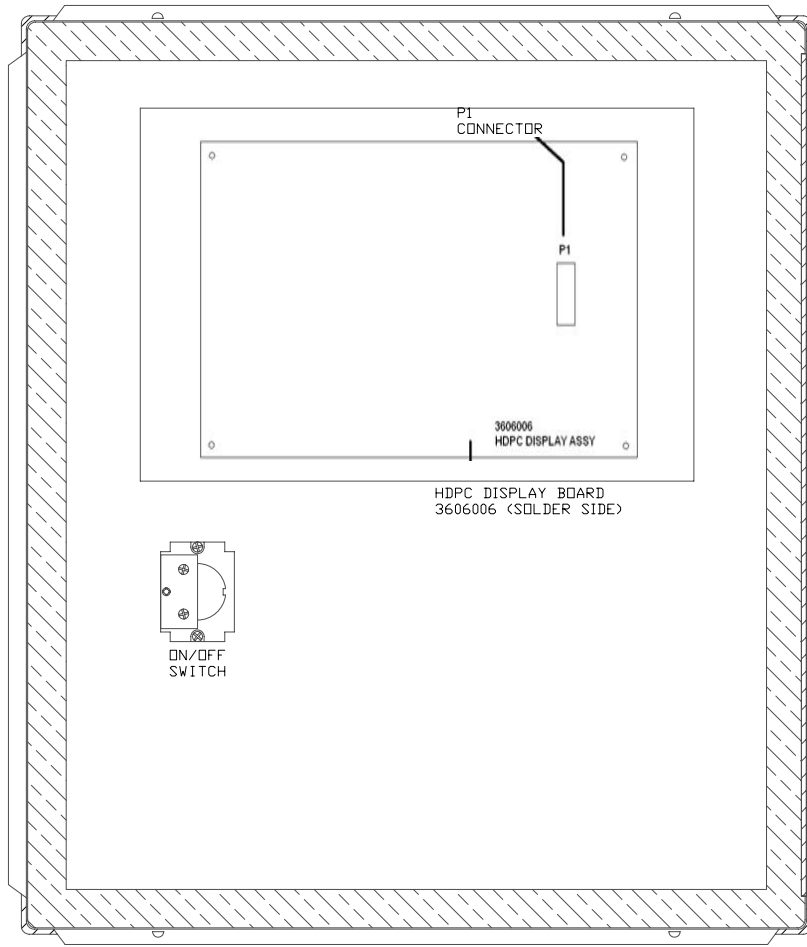

- SENSOR A CONNECTOR - P1
- SENSOR B CONNECTOR - P2
- SENSOR C CONNECTOR - P3

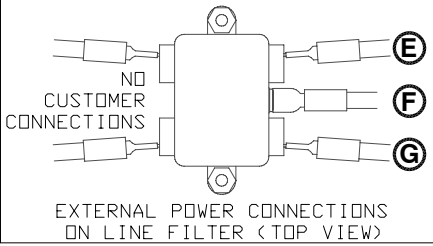

NOTE: LINEAR TOLERANCES ±0.010" (0.254MM) UNLESS NOTED. CUMULATIVE TOLERANCES NOT TO EXCEED 0.025" (0.625MM) UNLESS NOTED. HOLE TOLERANCES +0.010"/-0.000" [+0.025MM/-0MM] UNLESS NOTED. ANGULAR TOLERANCES NOT TO EXCEED 2° UNLESS NOTED.

HARRIS INSTRUMENT Corporation
155 Johnson Drive
Delaware, Ohio 43015 U.S.A.

SCAN LINE

Page	Size	Scale	Drawn by	Date	Approved by	Date
1	A	1:3	BLA	04/22/06		
Part Revision	DWG Revision	EVD #	EPS #	Standard Finish	Assembly #	
A	B	N/A	N/A	N/A	Blue Polane Paint	
Drawing Title						Old Drawing #
Interior View, Model HDPC						
Drawing #						1306005

This drawing copyright 1997 by Harris Instrument Corp. This drawing contains information which is the proprietary property of Harris Instrument Corp. Copies may not be made or the contents disclosed beyond the expressed authorization of Harris Instrument Corp. This print shall be returned upon request. All rights reserved.

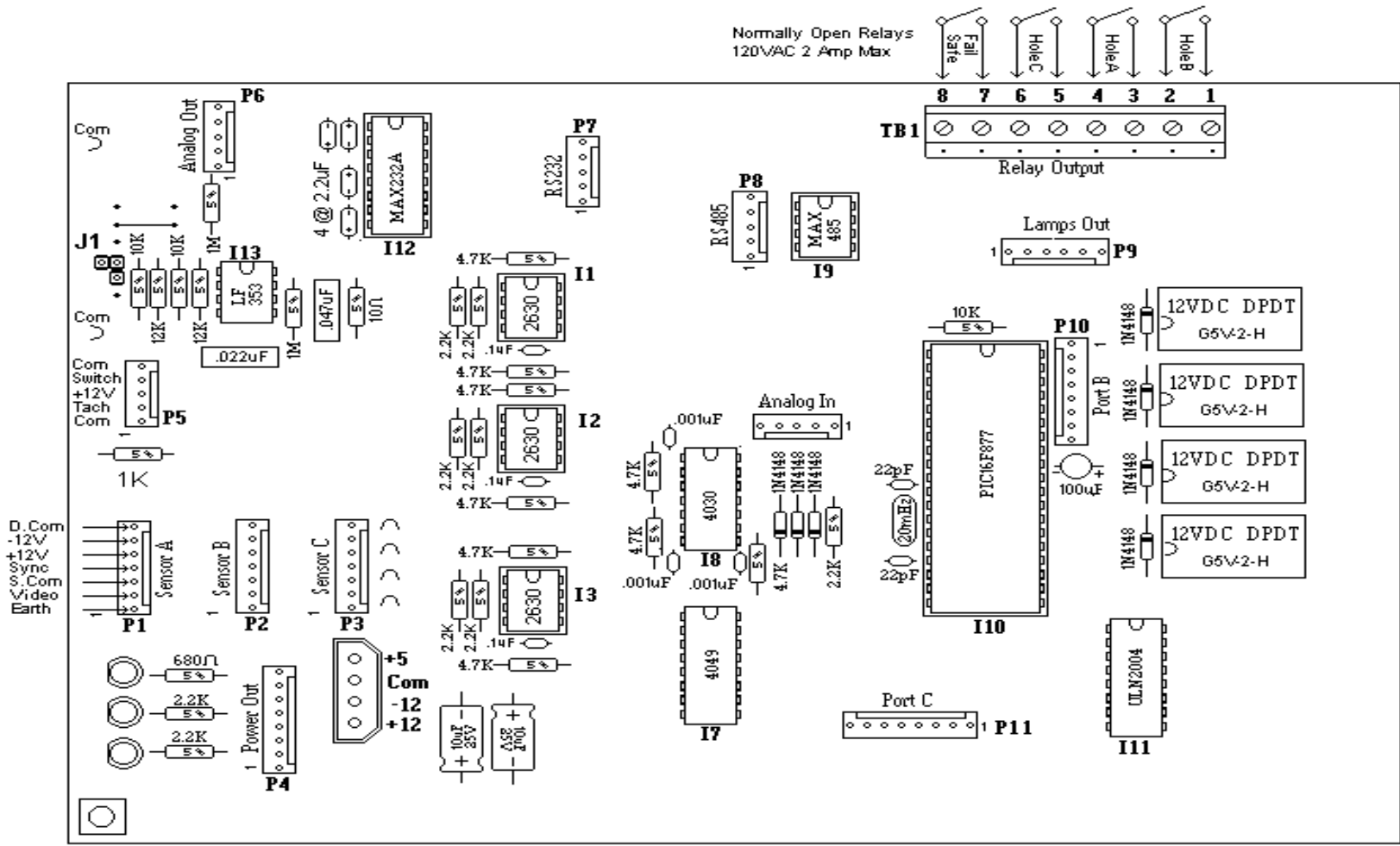

NOTE: LINEAR TOLERANCES ±0.010" (0.254MM) UNLESS NOTED. CUMULATIVE TOLERANCES NOT TO EXCEED 0.025" (0.625MM) UNLESS NOTED. HOLE TOLERANCES +0.010"/-0.000" (+0.25MM/-0MM) UNLESS NOTED. ANGULAR TOLERANCES NOT TO EXCEED 2° UNLESS NOTED.

HARRIS INSTRUMENT Corporation
155 Johnson Drive
Delaware, Ohio 43015 U.S.A.



This drawing copyright 2000 by Harris Instrument Corp. This drawing contains information which is the proprietary property of Harris Instrument Corp. Copies may not be made or the contents disclosed beyond the expressed authorization of Harris Instrument Corp. This print shall be returned upon request. All rights reserved.

Page	Size	Scale	Drawn by	Date	Approved by	Date
1/1	A	N.T.S.	BLA	04/18/06		
Part Revision		DWG Revision		EVO #	EPS #	Standard Finish
2				N/A	N/A	N/A
Material				Assembly #		
				N/A		
Drawing Title				Old Drawing #		
HOLE DETECTOR PROCESS COMP. AAHDC4				N/A		
				Drawing #		
				3605022		

Date	Rev	Record	Auth	ECN #	Reference
07/08/97	A	Change 4-pin Insert Gender	BW		711-0-TACHMETER Accu-Coder Dimensions
04/23/99	B	Change Ground Wire to Gray	SC		3497058 Rev D Bulkhead Wire Harness Diagram

TO ACCU-CODER TACHOMETER

PIN	COLOR	PAIR	FUNCTION
A	N/C	N/C	N/C
B	RED	R/B	+12VDC POWER
C	N/C	N/C	N/C
D	WHITE	G/W	TACHOMETER OUTPUT
E	N/C	N/C	N/C
F	GRAY	R/B	COMMON-POWER/OUTPUT

6-PIN CIRCULAR SOCKET INSERT (FEMALE)

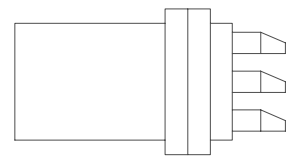

SIDE VIEW

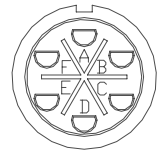

REAR VIEW SOLDER SIDE

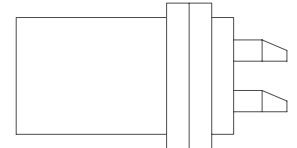

SIDE VIEW

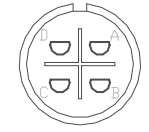

REAR VIEW SOLDER SIDE

TO 4-PIN CIRCULAR MALE BULKHEAD CONNECTOR ON BOTTOM PANEL OF MPPU

PIN	COLOR	PAIR	FUNCTION
A	GRAY	R/B	COMMON-OUTPUT/POWER
B	RED	R/B	+12VDC POWER
C	WHITE	G/W	TACHOMETER OUTPUT
D	SHIELD	N/A	SHIELD

4-PIN CIRCULAR SOCKET INSERT (FEMALE)

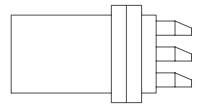

①

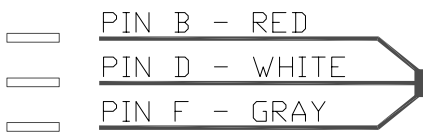

②



③

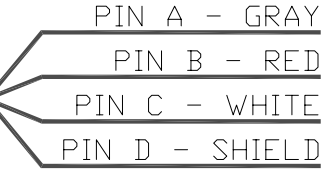

②

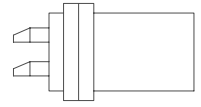

④

NOTE: SHELLS NOT SHOWN FOR CLARITY

CABLE: STANDARD = 5', MAXIMUM = 150'; BELDEN 8723 OR EQUIVALENT.

NOTE: CIRCULAR CONNECTORS AMPHENOL OR EQUIVALENT.

ALL WIRES STRIPPED & TINNED.

ITEM	PART NUMBER	QTY	DESCRIPTION
1	6007004	1	AMPHENOL, 6-PIN FEMALE SOCKET INSERT
2	6700003	7	HEAT SHRINK, FIT-221V-1/16 0.375"
3	7510002	1	WIRE, 4-CONDUCTOR WITH SHIELD L=5'
4	6007002	1	AMPHENOL, 4-PIN FEMALE SOCKET INSERT
N/A	6007104	2	AMPHENOL, 14S SHELL
N/A	6007050	2	AMPHENOL, STRAIN RELIEF

NOTE: LINEAR TOLERANCES ±0.010" [0.254MM] UNLESS NOTED. CUMULATIVE TOLERANCES NOT TO EXCEED 0.025" [0.625MM] UNLESS NOTED. HOLE TOLERANCES +0.010"/-0.000" [+0.025MM/-0MM] UNLESS NOTED. ANGULAR TOLERANCES NOT TO EXCEED 2° UNLESS NOTED.

HARRIS INSTRUMENT Corporation
155 Johnson Drive
Delaware, Ohio 43015 U.S.A.

SCAN LINE

Page	Size	Scale	Drawn by	Date	Approved by	Date
1/1	A	N/A	MCM	06/12/97		
Part Revision	B	DWG Revision	EVD #	EPS #	Standard Finish	
			N/A	N/A	N/A	
Material	Belden 8723 or Equivalent				Assembly #	N/A
Drawing Title	Cable, 6-pin Female-to-4-pin Female for MTI Option (Tachometer)				Old Drawing #	N/A
					Part #	3497059

This drawing copyright 1997 by Harris Instrument Corp. This drawing contains information which is the proprietary property of Harris Instrument Corp. Copies may not be made or the contents disclosed beyond the expressed authorization of Harris Instrument Corp. This print shall be returned upon request. All rights reserved.

